

ARIELLA

PRIVATE ESTATE

Look forward
to connecting
with nature.



Look forward to taking time out.

Look forward to exploring your new home, its surrounding area and everything it has to offer.

There's no shortage of family favourites right outside your door just waiting to be discovered. Take time out in the fun playgrounds and wide-open spaces where you and your family can play.



Ariella Adventure Park

The latest piece of amenity for Brabham residents to enjoy has opened on Estoril Approach in Ariella's North. This large park features an abundance of retained Marri & Melaleuca trees, a dragonfly play structure, walking trails, grassy kick about areas, community BBQs and shade structures for residents to keep cool all year long.



Brabham Neighbourhood Park

Exciting news for residents living in Ariella with the Brabham Neighbourhood Park now complete and open to the public. Situated next to the brand new Brabham Primary School in Ariella Private Estate, the oval will serve for local community sports and for the neighbouring school. Residents can enjoy the spacious grassy oval with play space and practise cricket wickets.

Conservation Wetland Park

A weaving footpath will take you through the wetland, amongst the retained Melaleuca trees, through to Woolcott Avenue, providing an opportunity to keep a lookout for the native flora that call this wetland their home. Play is centred around discovery and nature, providing children with endless opportunities for imaginative play with slides, stepping logs, balance beams, and a cubby house. Enjoy a picnic under the shade, while the children explore the nature play equipment.



Walking Trails

A weaving footpath will take you amongst the Melaleuca trees. Look for the native flowers that call this their home.

Future Pocket Parks

With more public open spaces still to come, you'll find so many opportunities to relax and connect with nature.

Look forward
to making new
discoveries.



Ariella Adventure Park



Future Parks



Brabham Neighbourhood Park



Conservation Wetland

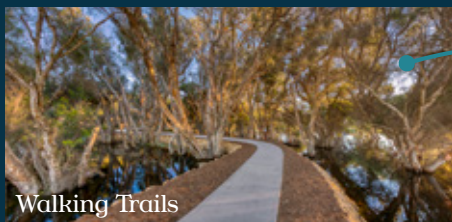

Walking Trails

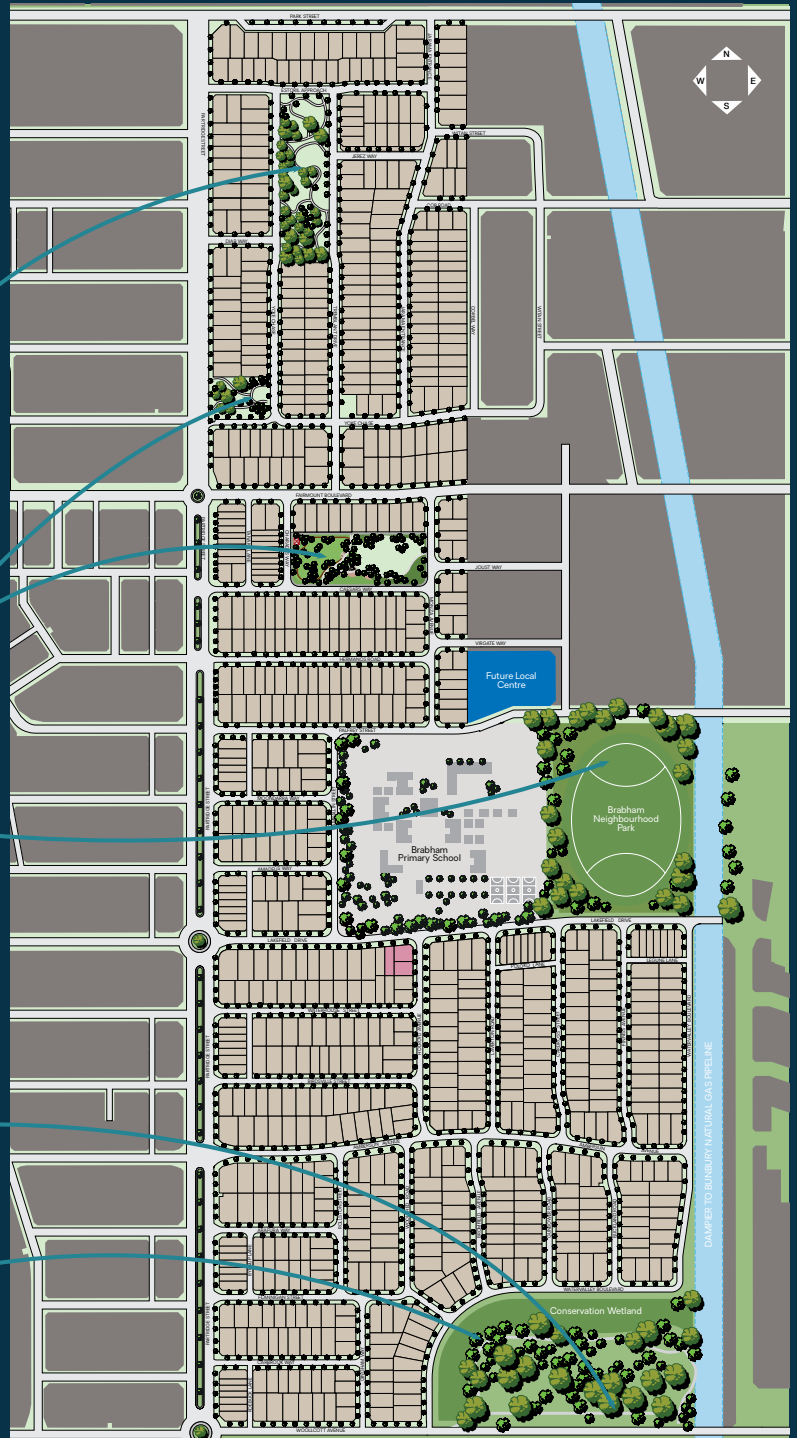

Look forward to a ready-made community.

Look forward to a future full of community. An established community is waiting to welcome you as you embark on this next exciting chapter of your life.



20km from
Perth CBD



Surrounded
by nature



Walk to schools,
shops & more



Range of blocks
available

Ariella Sales Office

Corner of Lakefield Drive
& Holroyd Avenue, Brabham

1 - 5 pm Mon, Wed, Sat & Sun

For more information contact

1300 294 523 or email
ariella@cedarwoods.com.au

ariellaprivateestate.com.au

ARIELLA
PRIVATE ESTATE

**CEDAR
WOODS**
DEVELOPING TOMORROW TODAY